

Specifications

Specifications



Model	Fengfan Type	Ah	CCA	RC	Dimensions(mm)	Weight(kg)	Cell Out	Terminal Model	Hold Down Type
LN1 / H4	AGM50	50	540	80	207*175*190	15	0	1	B13
LN2 / H5	AGM60	60	680	100	242*175*190	18	0	1	B13
LN3/ H6	AGM70	70	760	120	278*175*190	21	0	1	B13
LN4 / H7	AGM80	80	800	140	315*175*190	24.5	0	1	B13
LN5 / H8	AGM95	95	900	160	353*175*190	27.9	0	1	B13
LN6/ H9	AGM105	105	950	190	394*175*190	31	0	1	B13





European

Case	Fengfan Type	Ah	CCA	Dimensions(mm)	Cell Out	Terminal Model	Hold Down Type
LN2 / H5	EFB60	60	660	242*175*190	0	1	B13
LN3/ H6	EFB70	70	700	278*175*190	0	1	B13
LBN4/T7	EFB75	75	730	315*175*175	0	1	B13

Asian

Case	Fengfan Type	Ah	CCA	Dimensions(mm)	Cell Out	Terminal Model	Hold Down Type
B20	M42L	40	400	197*129*227	0	3	B0
B20	M42R	40	400	197*129*227	1	3	B0
B24	N55L	55	500	238*128*224	0	3	B0
B24	N55R	55	500	238*128*224	1	3	B0
D23	Q85L	70	600	229*172*222	0	1	B0
D23	Q85R	70	600	229*172*222	1	1	B0
D26	S95L	75	680	259*172*222	0	1	B0
D26	S95R	75	680	259*172*222	1	1	B0
D31	T110	90	750	305*172*222	0	1	B0
D31	T100	90	750	305*172*222	1	1	B0



Specifications



Asian							
Group	Fengfan Type	Ah	CCA	Dimensions(mm)	Cell Out	Terminal Model	Hold Down Type
B19	55B19L	40	330	197*130*227	0	3	B0
	55B19R	40	330	197*130*227	1	3	B0
B24	75B24LS	48	430	238*129*223	0	1	B0
	75B24RS	48	430	238*129*223	1	1	B0
	75B24L	48	430	238*129*223	0	3	B0
	75B24R	48	430	238*129*223	1	3	B0
D23	95D23L	65	500	232*173*225	0	1	B0
	95D23R	65	500	232*173*225	1	1	B0
	105D23L	70	580	232*173*225	0	1	B0
	105D23R	70	580	232*173*225	1	1	B0
D26	85D26L	70	600	260*173*225	0	1	B1
	85D26R	70	600	260*173*225	1	1	B1
	115D26L	75	620	260*173*225	0	1	B1
	115D26R	75	620	260*173*225	1	1	B1
D31	135D31L	80	700	305*173*225	0	1	B1
	135D31R	80	700	305*173*225	1	1	B1

European							
Group	Fengfan Type	Ah	CCA	Dimensions(mm)	Cell Out	Terminal Model	Hold Down Type
LB1 / T4	54535	45	480	207*175*175	0	1	B13
LB2 / T5	56035	60	580	242*175*175	0	1	B3
L02 / H5	56535	65	600	242*175*190	0	1	B13
LB3 / T6	57035	70	680	278*175*175	0	1	B13
L03 / H6	57535	75	700	278*175*190	0	1	B13
L04 / H7	58043	80	800	315*175*190	0	1	B13
L05 / H8	60044	100	900	353*175*190	0	1	B13

Commercial Vehicles

Fengfan Heavy Duty Series car batteries incorporate glass mat separators in addition to its reinforced plates. With these special separators, cycle life and vibration resistance of batteries are longer and greater than regular batteries.

Maintenance Free Series

Group	Model	Fengfan Type	Ah	CCA	Dimensions(mm)	Weight(kg)	Cell Out	Terminal Model	Hold Down
E41	130E41L	N100MF	105	860	410*176*234	26.5	0	1	B0
	130E41R	N100MF	105	860	410*176*234	26.5	1	1	B0
F51	150F51L	N120MF	120	910	513*184*240	35	4	1	B0
G51	170G51	N150MF	150	1100	513*223*240	42	4	1	B0
H52	245H52	N200MF	200	1200	515*252*240	52	4	1	B0
		DIN140MF	140	800	513*184*240	36.5	3	1	B0
		DIN180MF	180	1000	513*223*240	45	3	1	B0



Dry Charged Series

Group	Model	Fengfan Type	Ah	CCA	Dimensions(mm)	Weight(kg)	Cell Out	Terminal Model	Hold Down
E41	130E41R	N100	105	860	409*170*227	16.5	1	1	B0
F51	150F51L	N120	120	910	505*182*237	22	4	1	B0
G51	170G51	N150	150	1000	510*223*237	27.6	4	1	B0
H52	245H52	DIN225	200	1200	520*277*244	41	4	1	B0
		DIN140	140	800	505*182*237	23.7	3	1	B0
		DIN180	180	1000	510*223*237	33	3	1	B0



好马配好鞍 好车配风帆

Cell Out

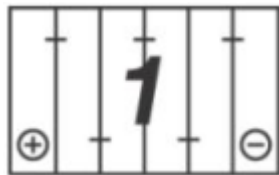
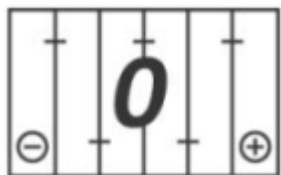

Terminal Model

负端子尺寸图
NEGATIVE TERMINAL

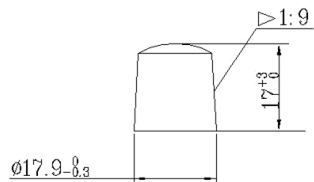

正端子尺寸图
POSITIVE TERMINAL

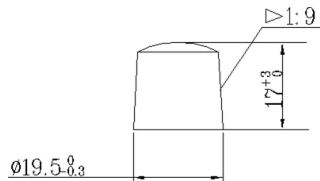

POSITIVE TERMINAL

正端子尺寸图

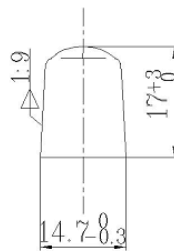

NEGATIVE TERMINAL

负端子尺寸图

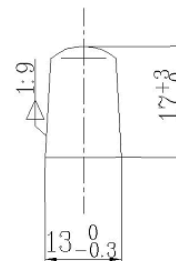

Hold Down

N



B1

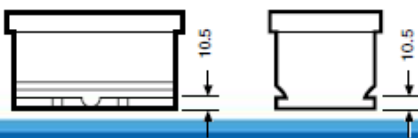

B3

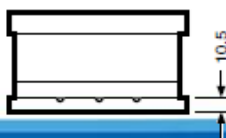

B13

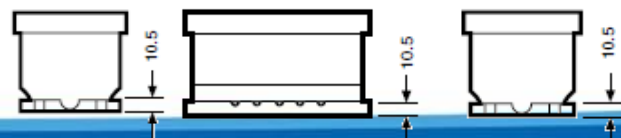

好马配好鞍

好车配风帆